

ASSEMBLY INSTRUCTION FOR AN ORGANIZER FOR THE BOARD GAME

Scythe

- For assembling you will need glue (we recommend the PVA glue), painter`s tape and utility knife
- According to the organizer`s assembly sequence separate the details from the form using a utility knife or squeeze them out with your fingers.
- Before gluing make sure that all the details are connected correctly. Check out this manual one more time and then use glue to the mating surfaces.
- While gluing the corner pieces, until the glue dries, you can “grab” the parts with a masking tape for a better contiguity.
- In rare cases, if the wooden details don`t fit in the technological grooves, you need to trim the corner of a tenon with a utility knife.

Explanation of Symbols



- while connecting the wooden parts together, place a thin layer of glue on the mating surfaces



- **do not use glue** while connecting the parts

1

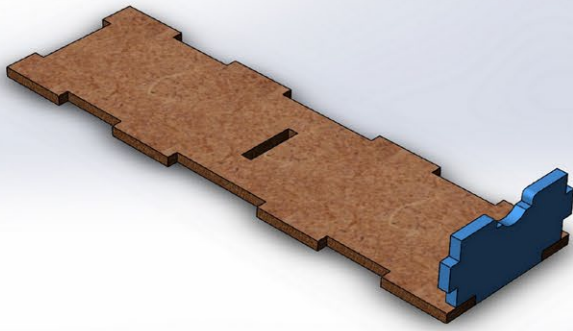

2

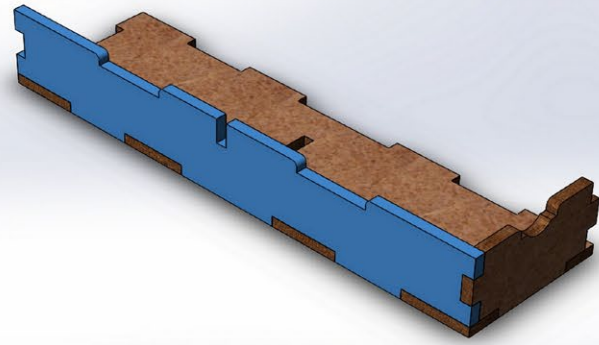

3

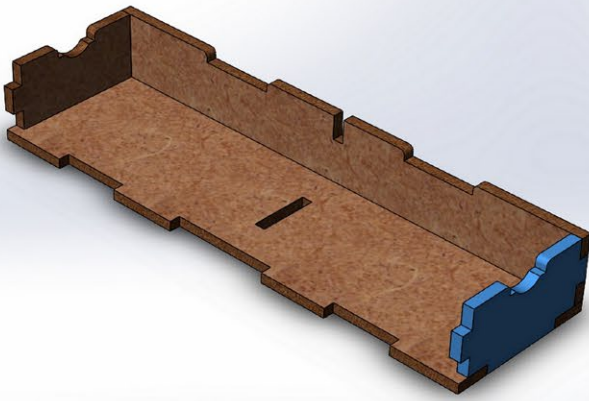

4

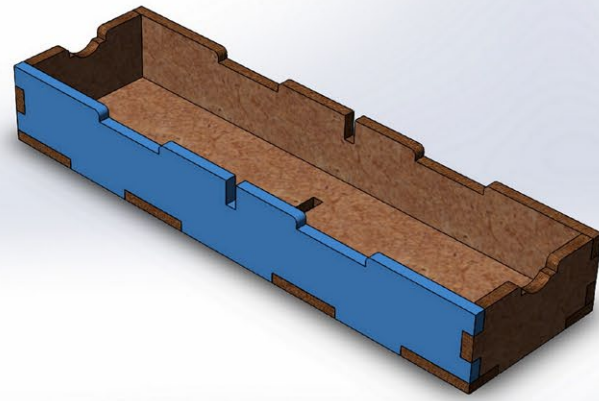

5

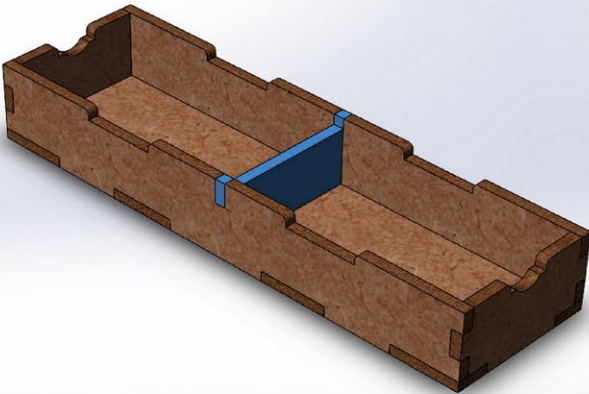

6

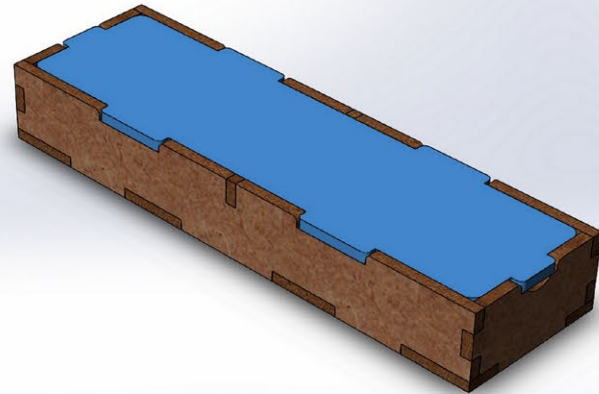

x2

1

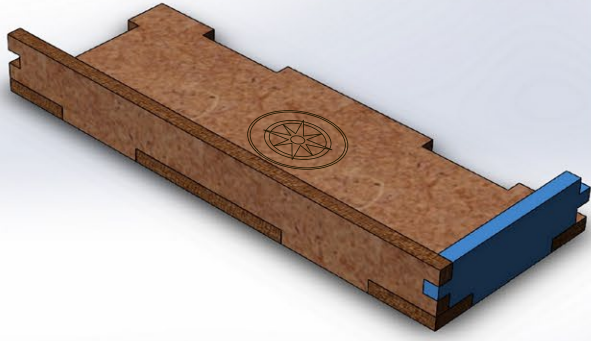

2

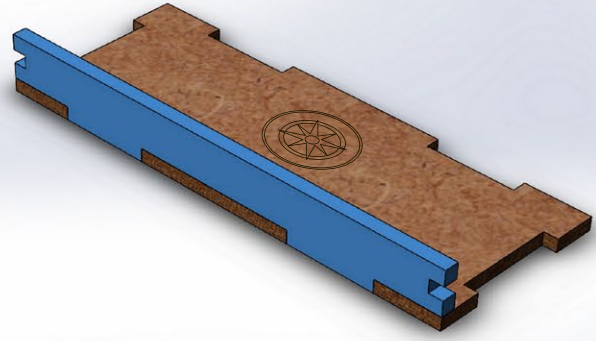

3



4

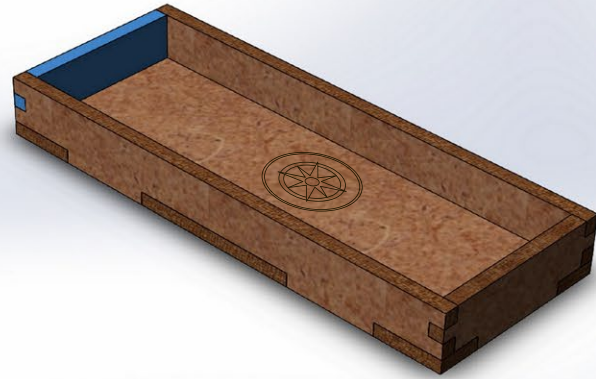

1

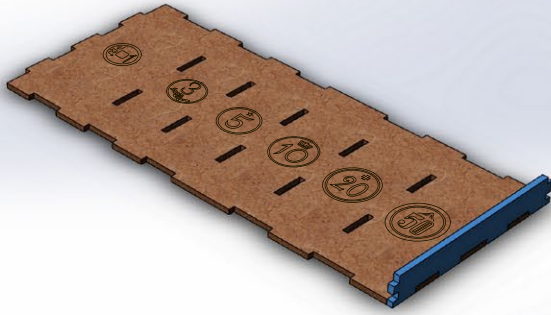

2

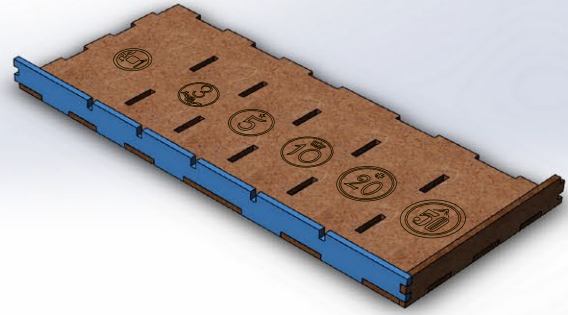

3

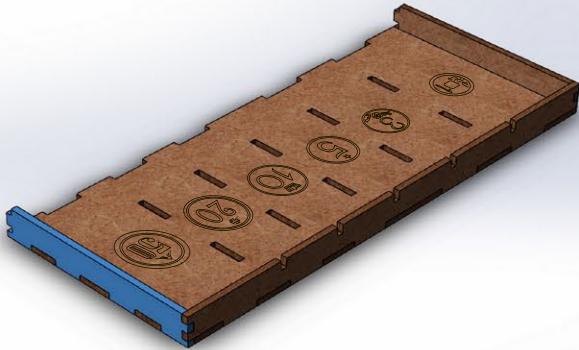

4

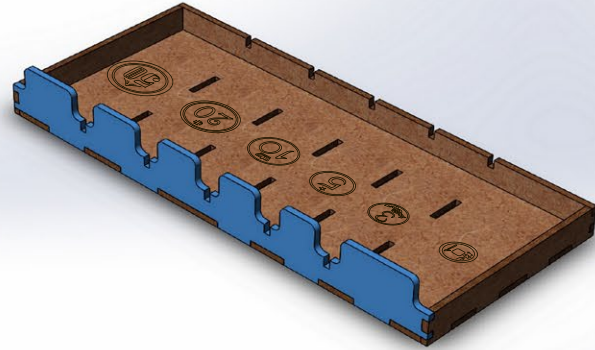

5



6



7



1

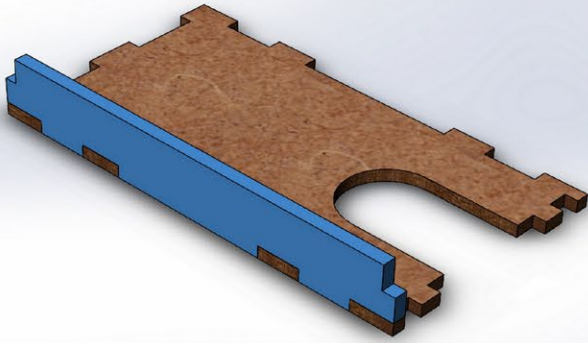

2

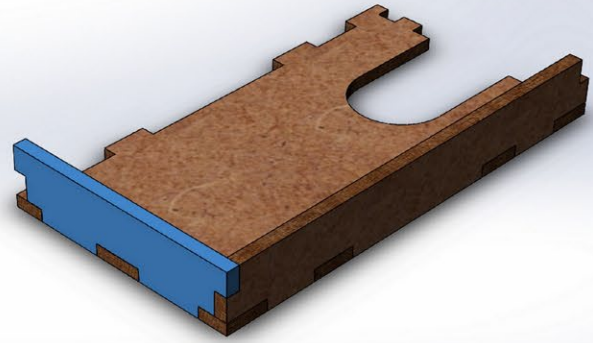

3

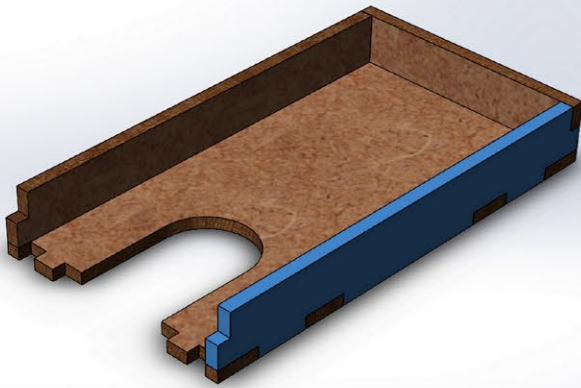

4

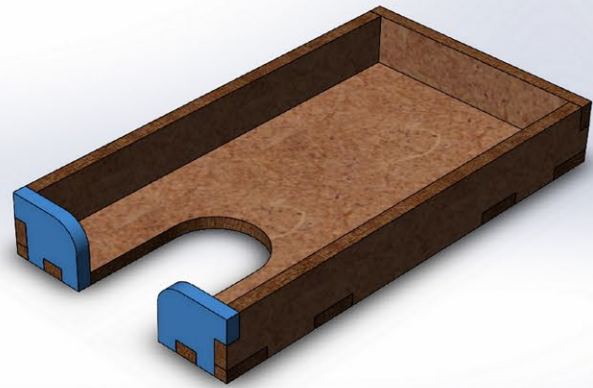

5

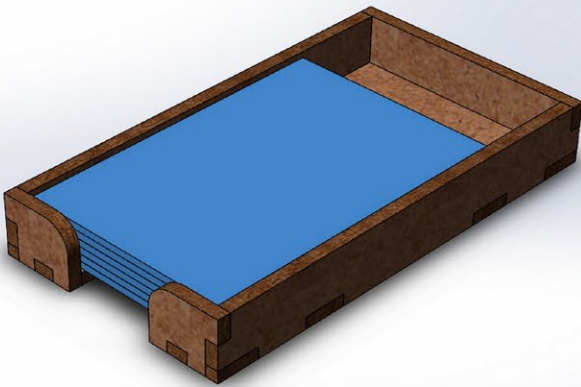

6



1

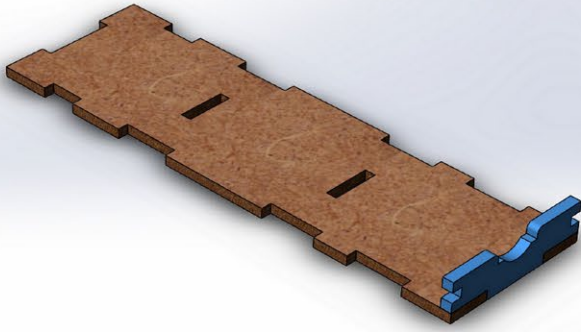

2

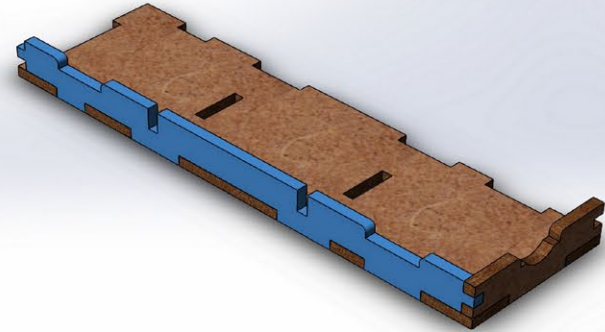

3

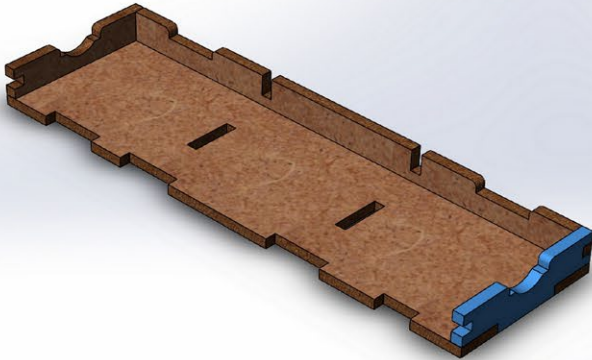

4

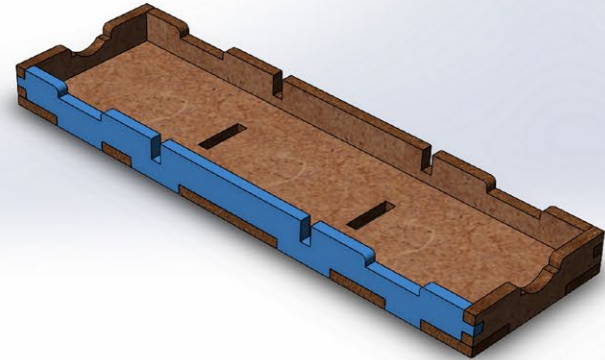

5

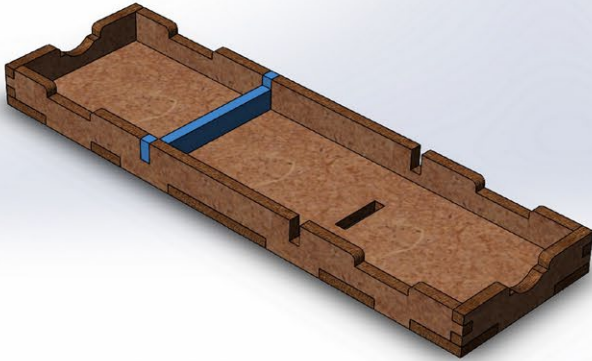

6

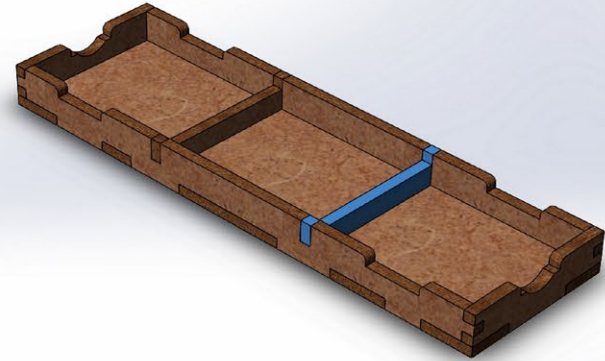

7

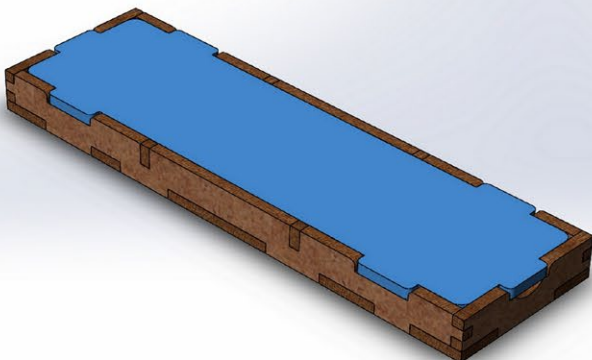

1

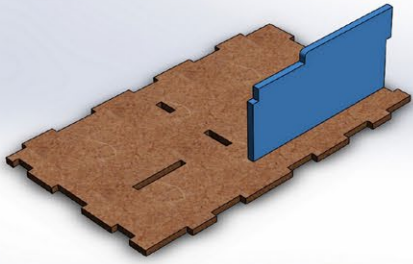

2

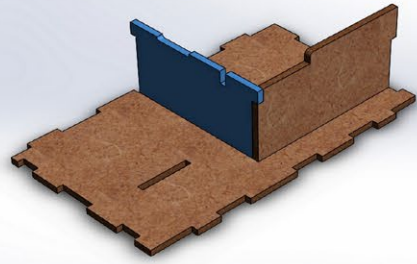

3

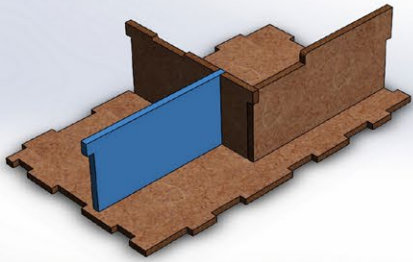

4

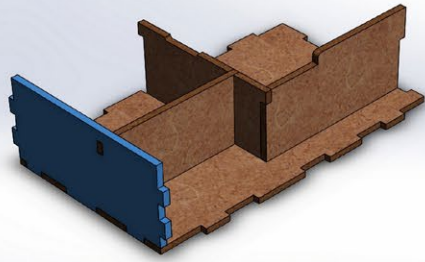

5

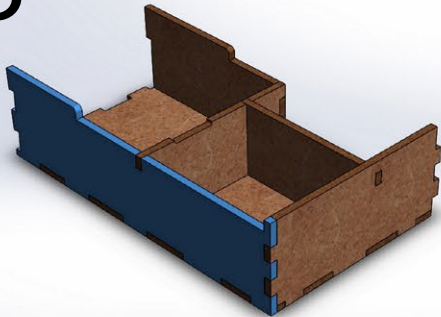

6

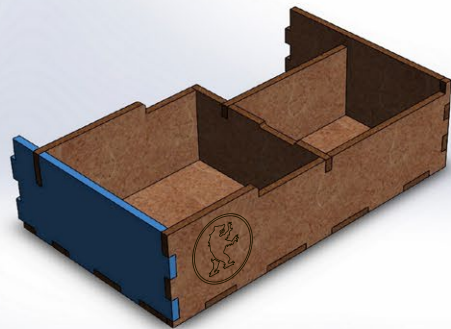

7

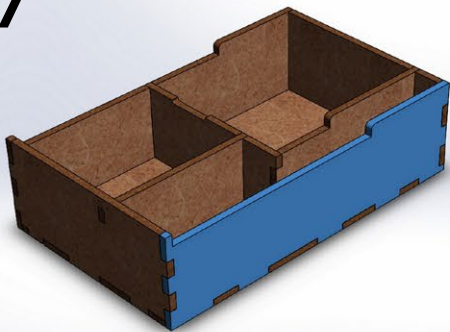

8

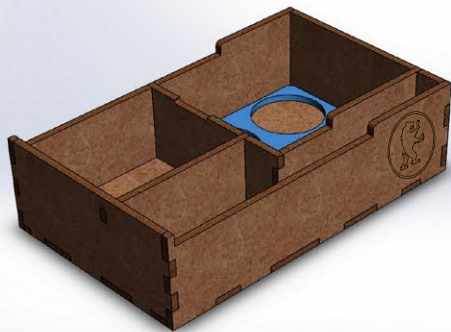

9

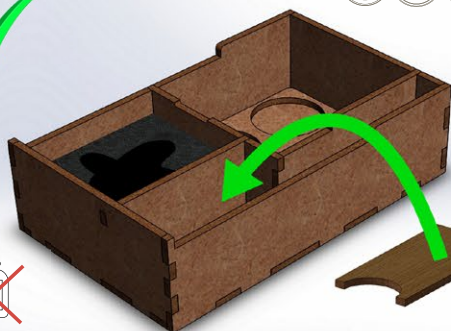
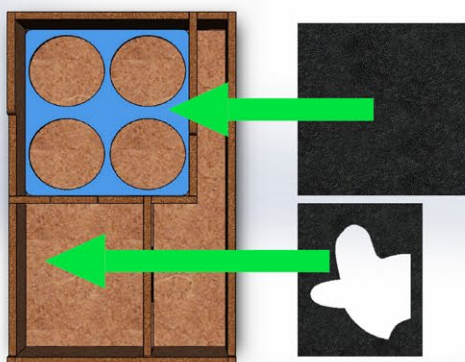

x7

8

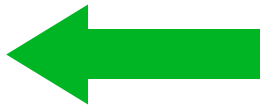
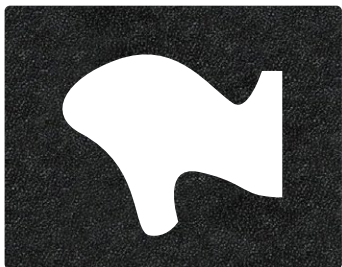
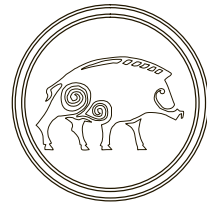
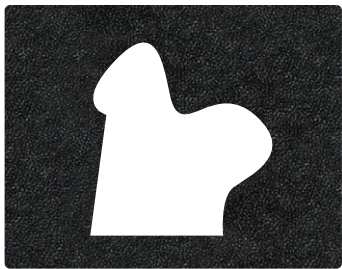
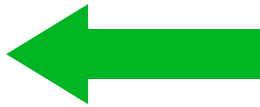
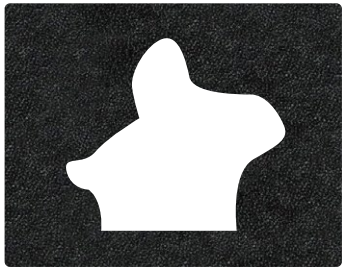
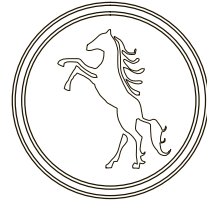
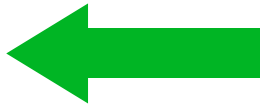
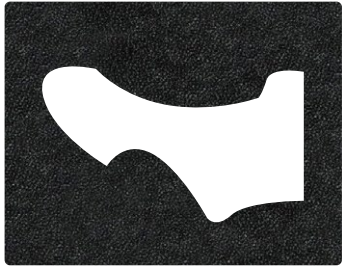
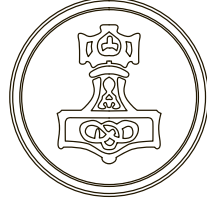
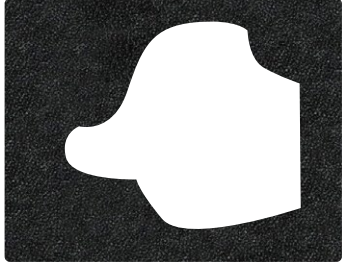
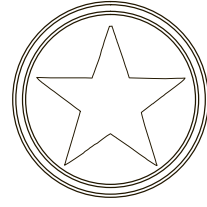
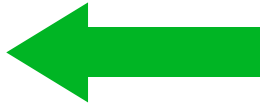
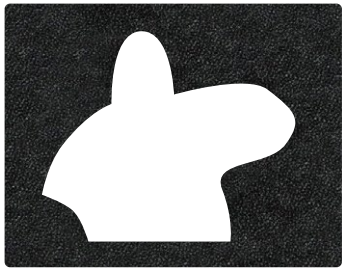

1

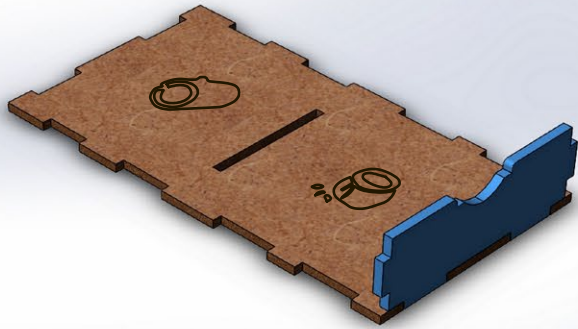

2

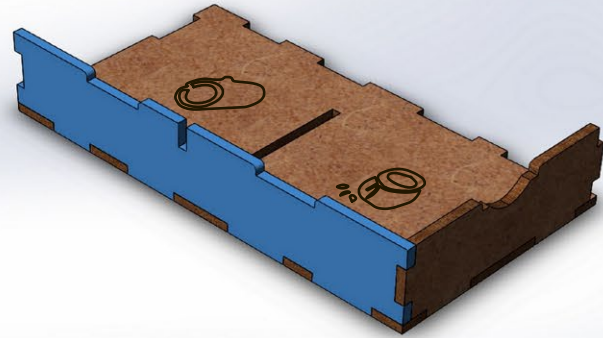

3

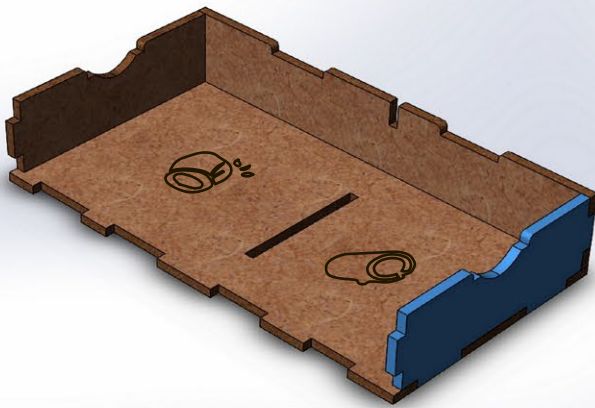

4

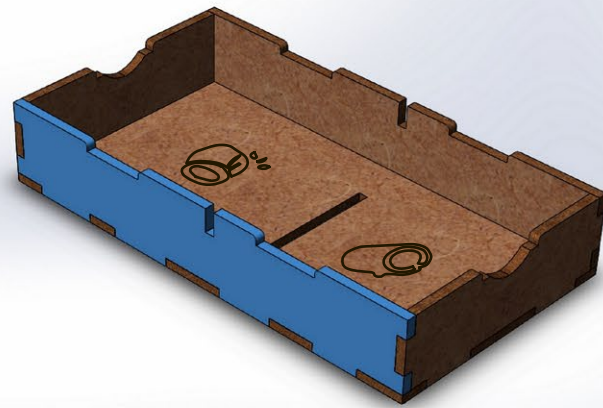

5

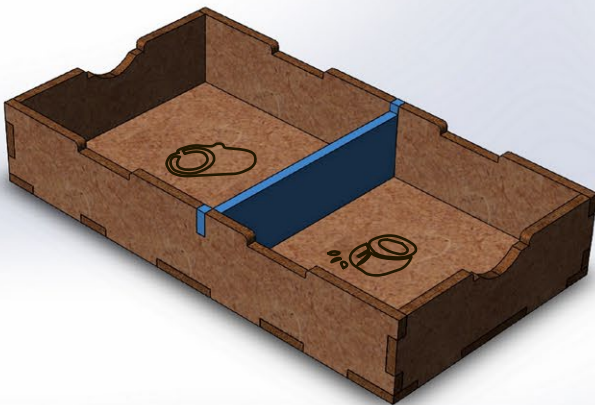

6

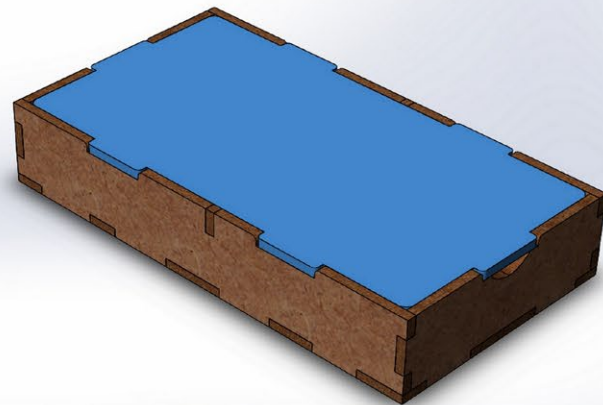

1

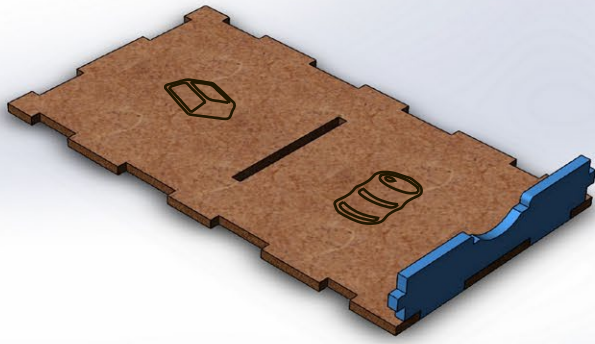

2

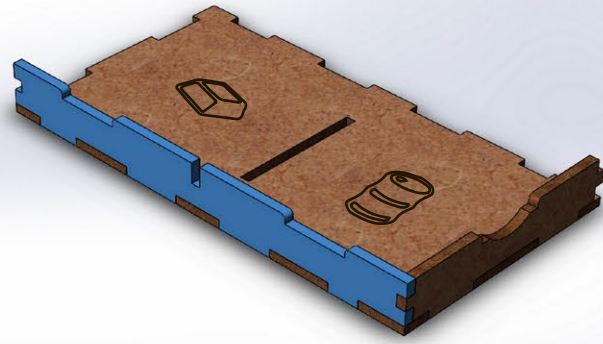

3

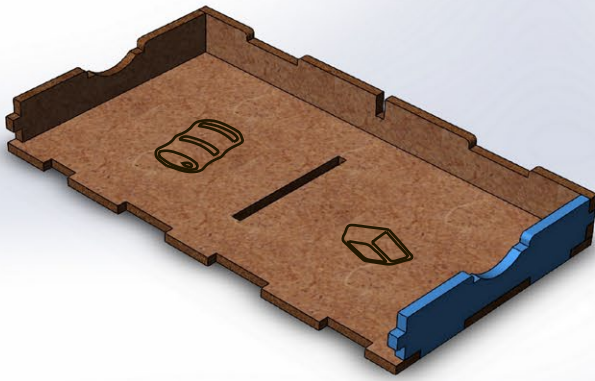

4

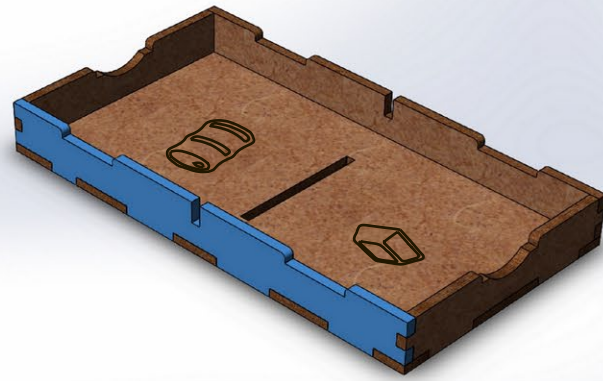

5

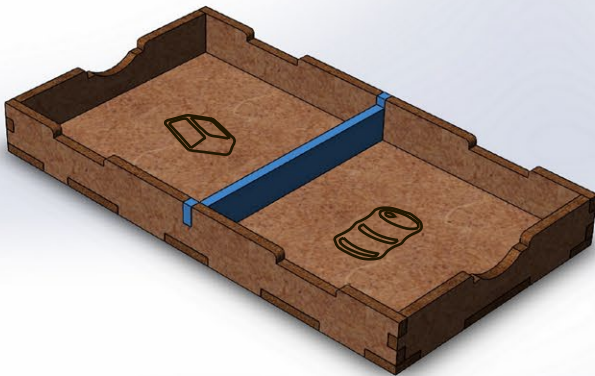

6

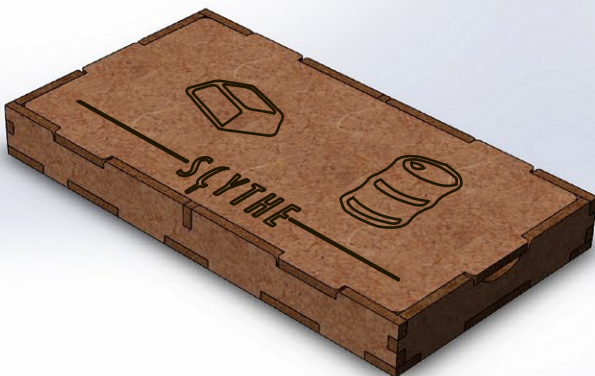
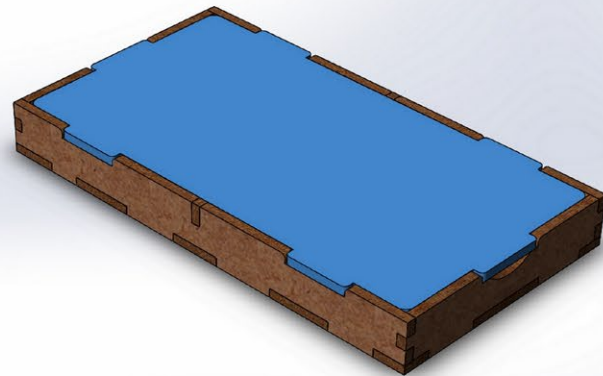

1

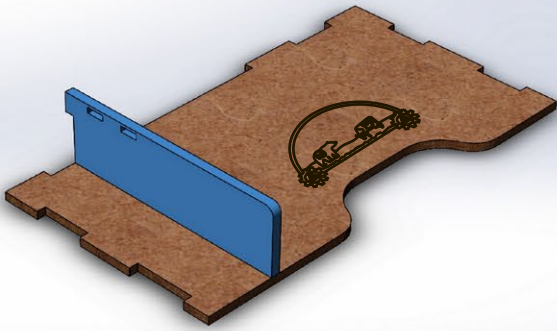

2

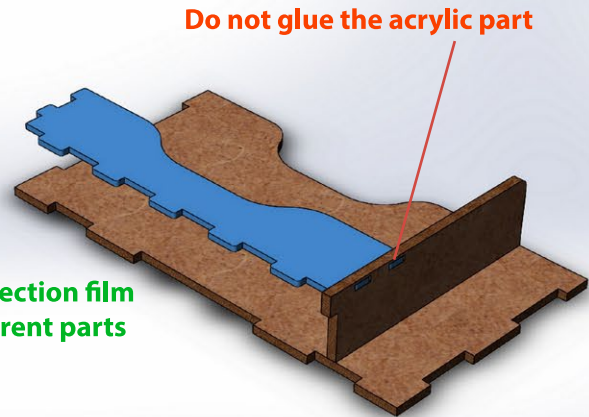

Remove protection film from transparent parts



Acrylic parts may differ from this picture

3

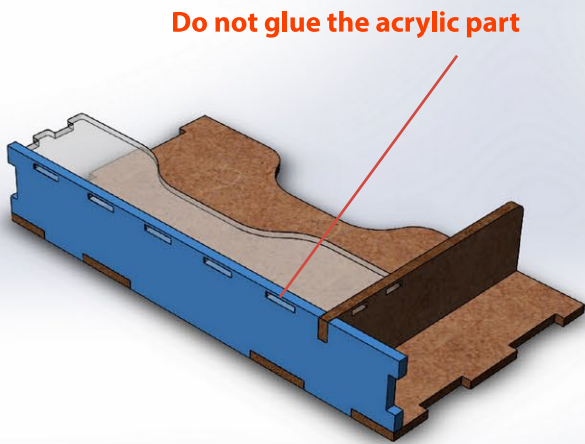

4

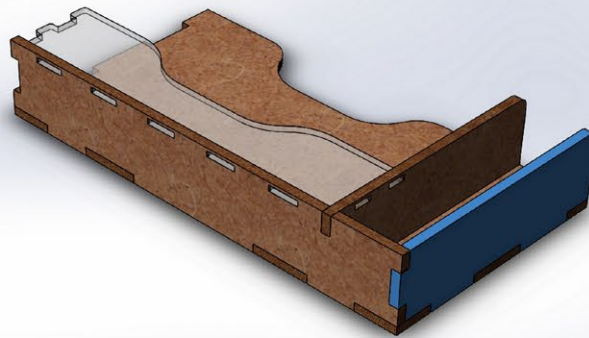

5

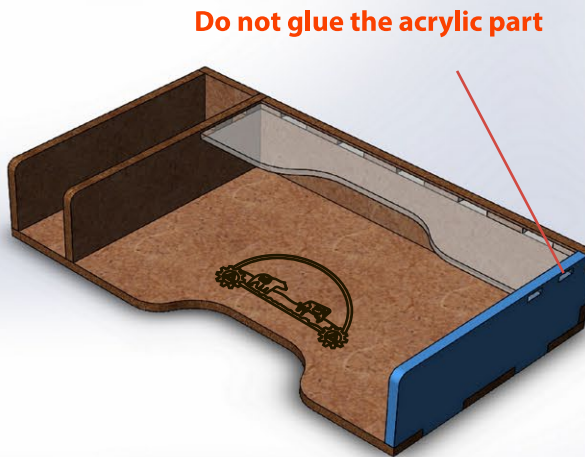

6

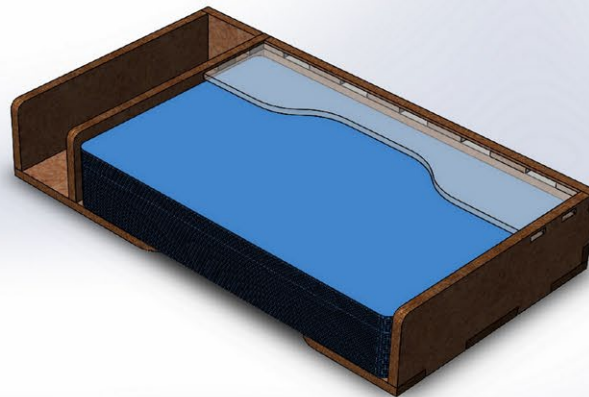

1

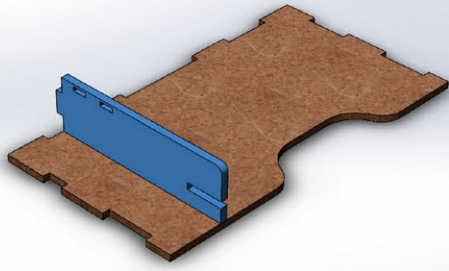

2

Remove protection film from transparent parts

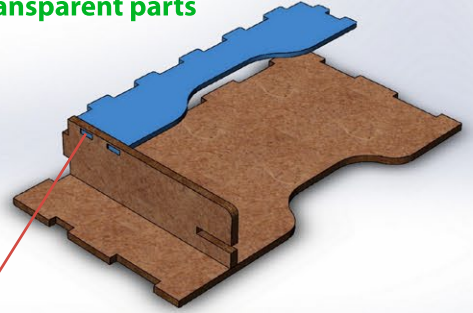

Do not glue the acrylic part

3

Do not glue the acrylic part

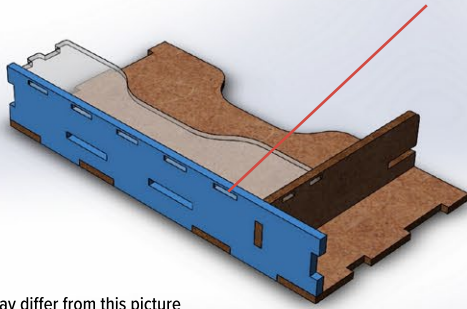

Acrylic parts may differ from this picture

4

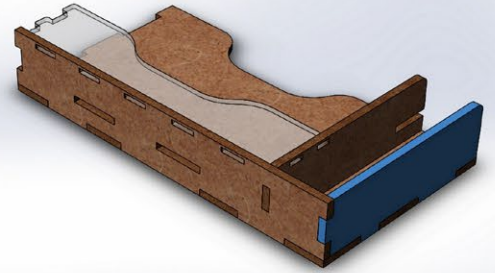

5

Do not glue the acrylic part

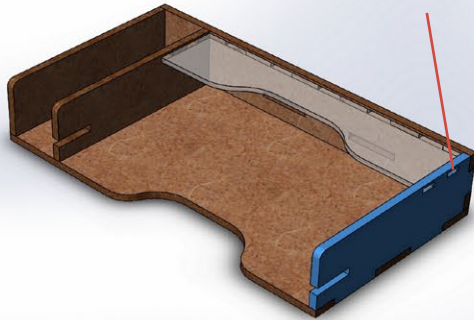

6

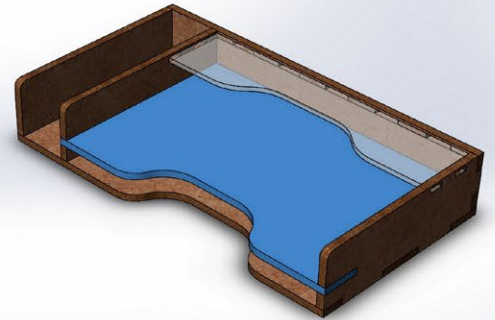

7

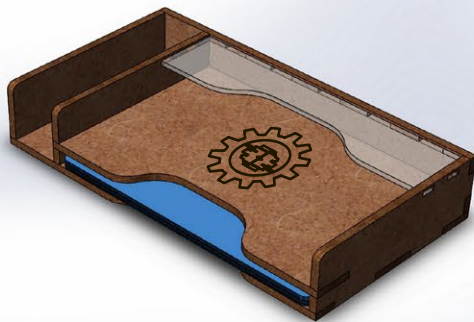

8

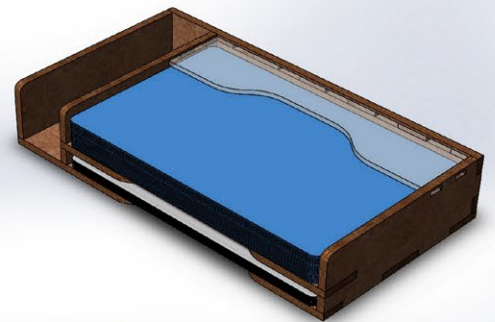

1

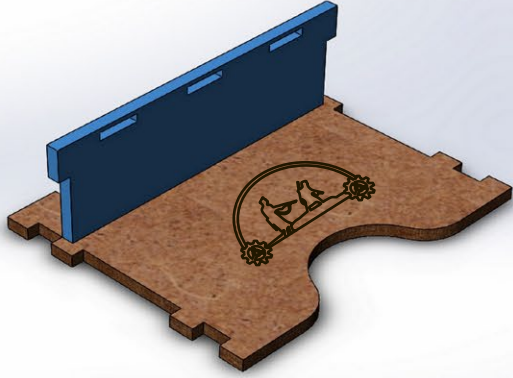

2

Remove protection film from transparent parts

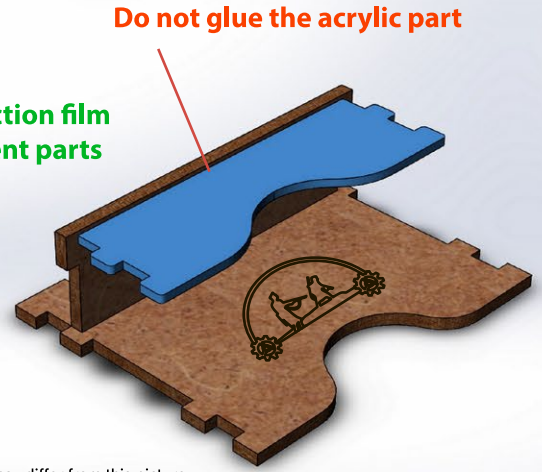

3

Do not glue the acrylic part

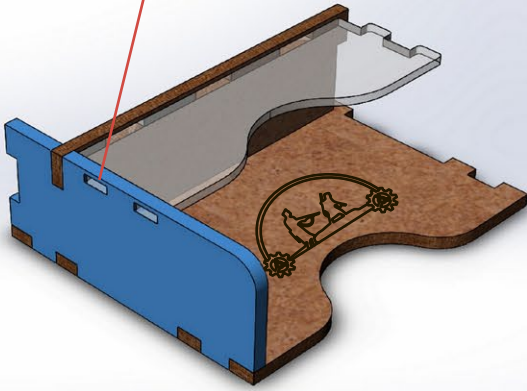

4

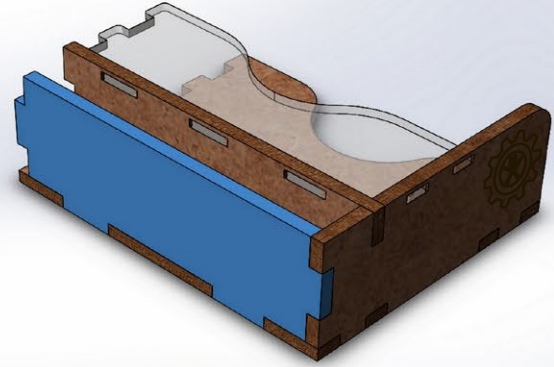

5

Do not glue the acrylic part

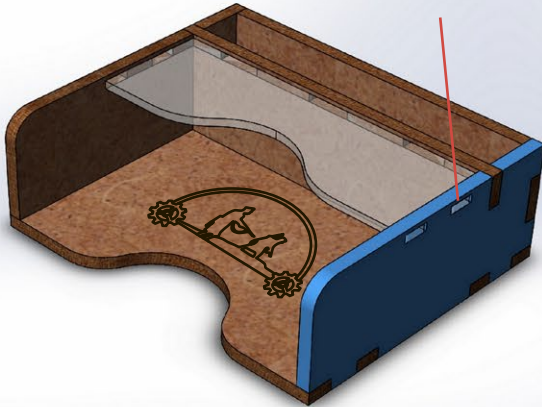

6



1

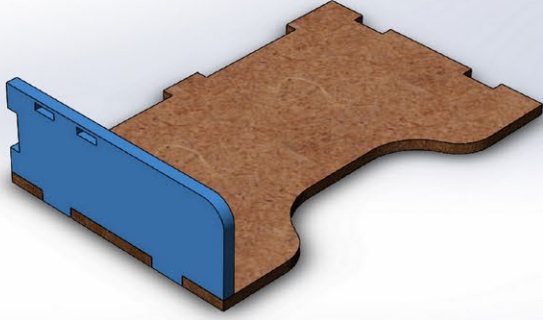
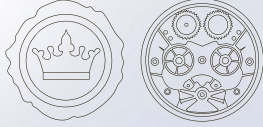

2

Acrylic parts may differ from this picture

Do not glue the acrylic part

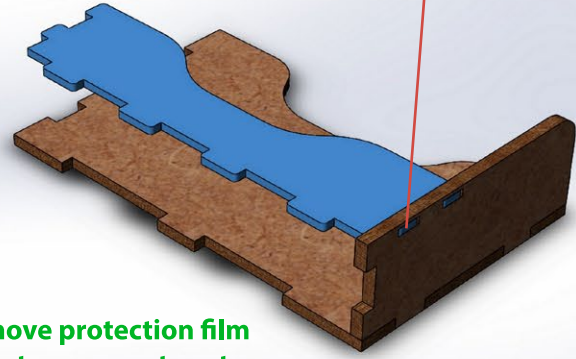

Remove protection film from transparent parts

3

Do not glue the acrylic part

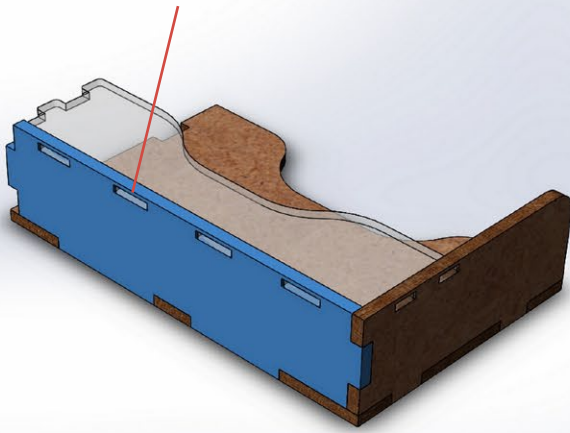

4

Do not glue the acrylic part

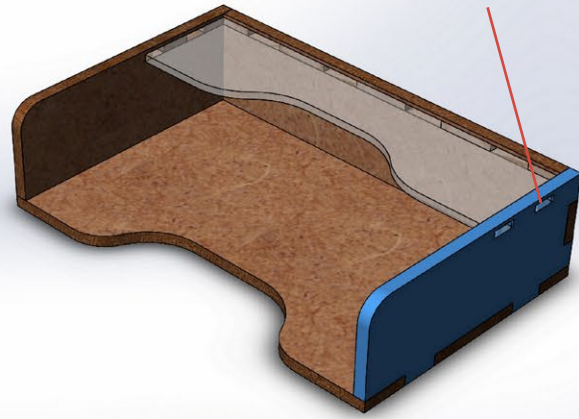

5

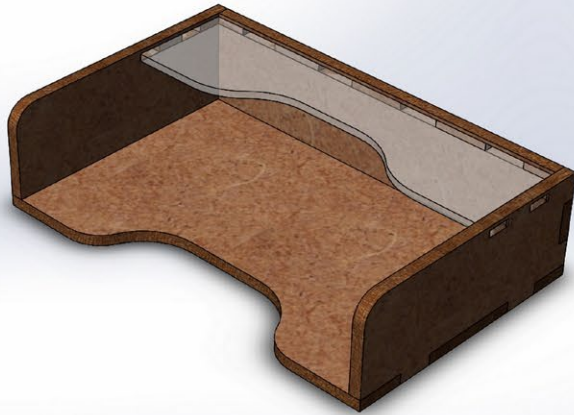

x2

6

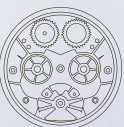
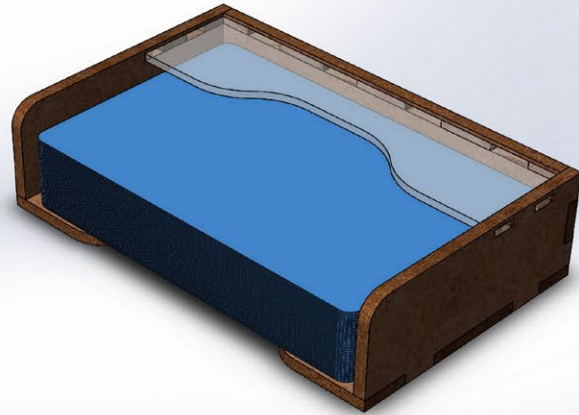

1

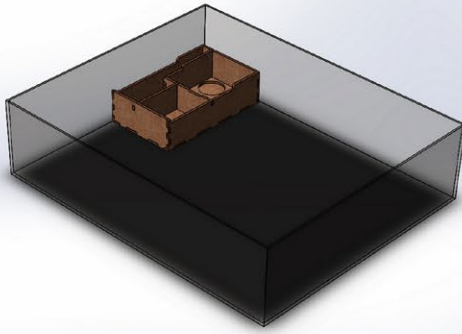

2

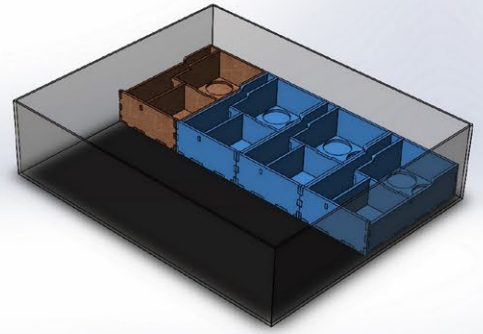

3

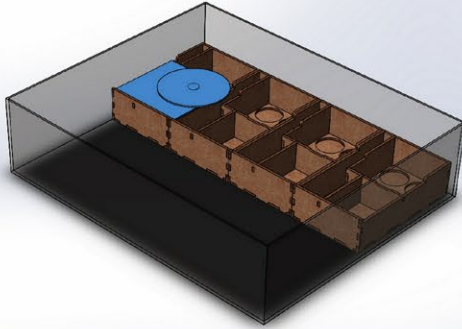

4

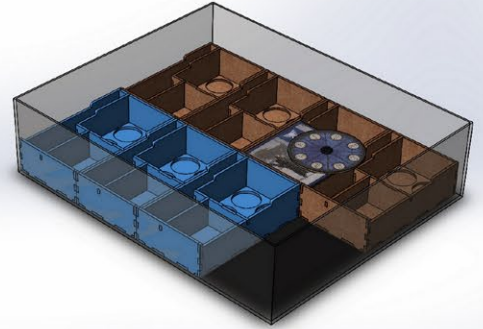

5

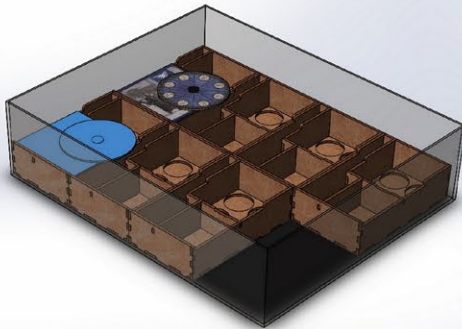

6

for Kickstarter version only

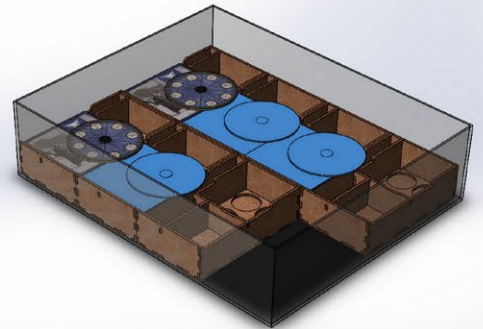

7

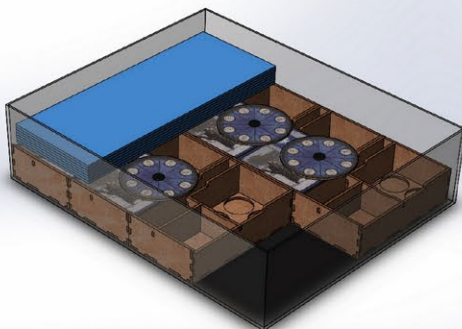

8

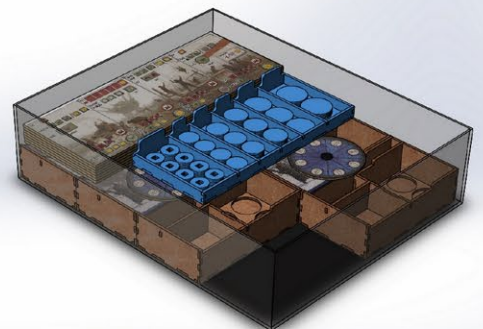

9

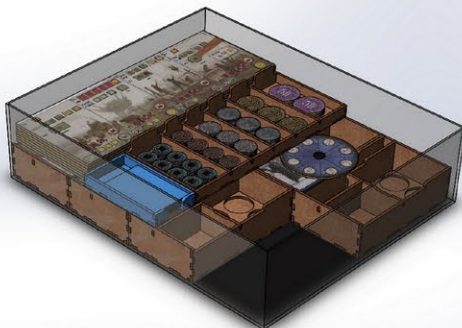

10

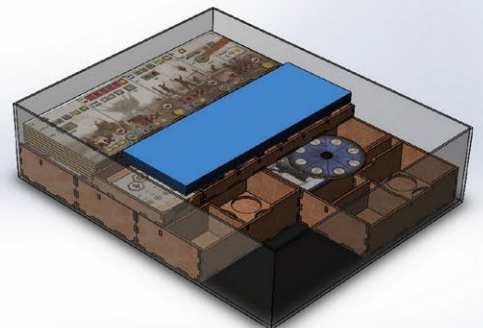

11

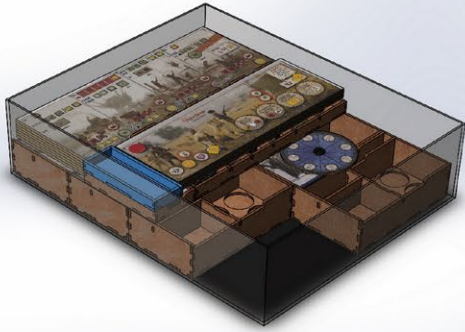

12

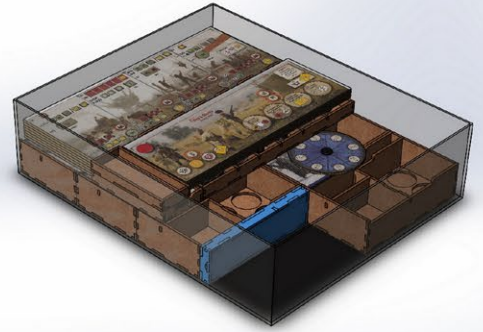

13

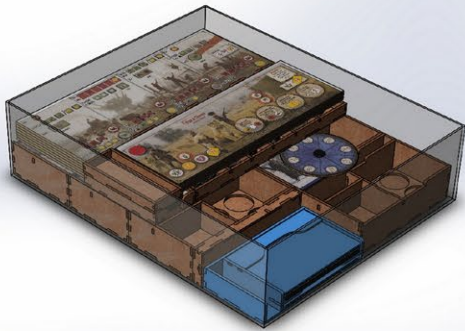

14

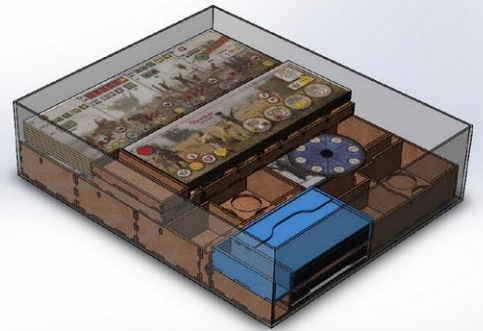

15

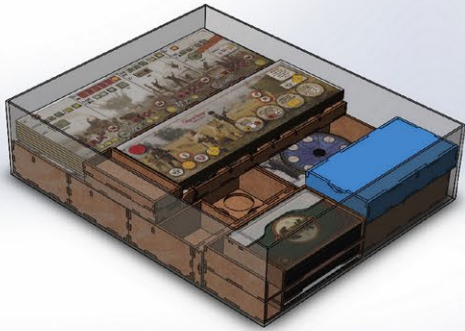

16

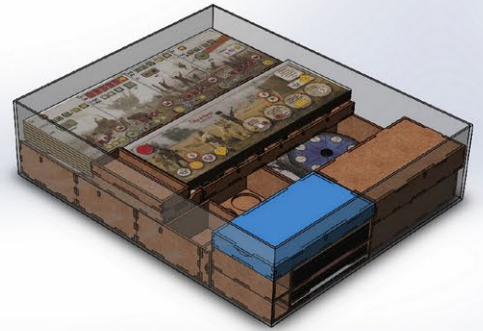

17



18



19

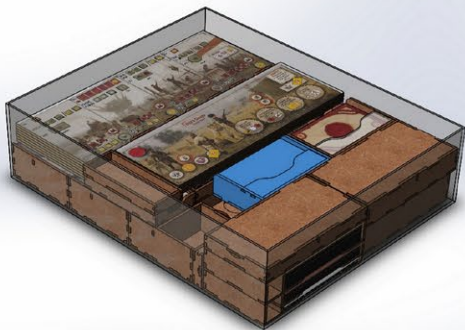

20

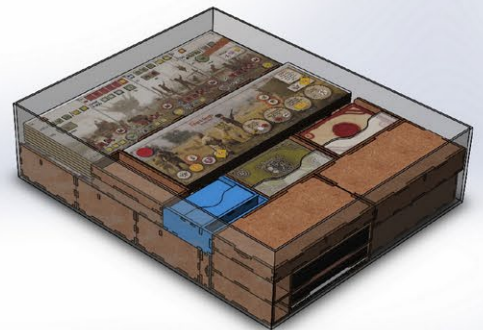

21

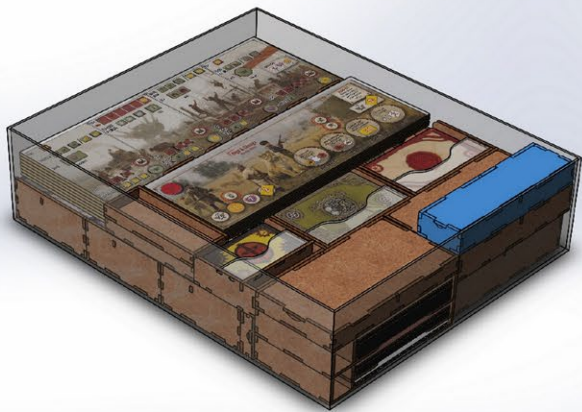

22

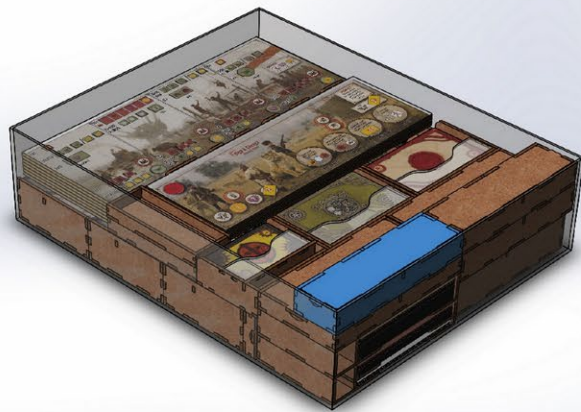

23

the additional gameboard

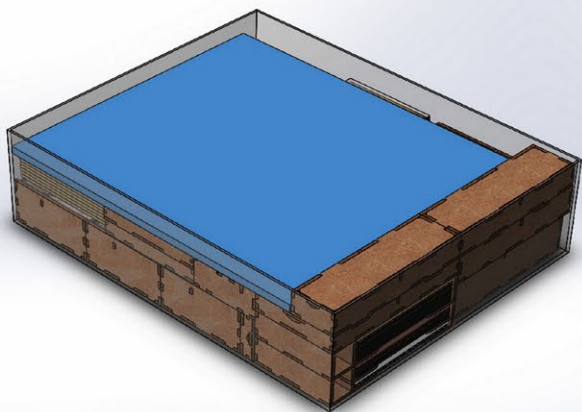

24



25

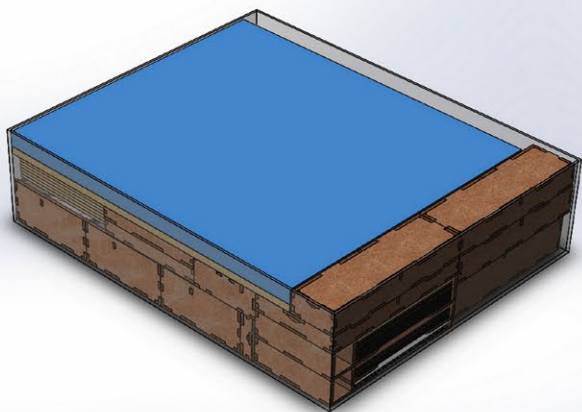

26



27

